

Gas-fired convection heaters

W - WR - WD

air-tight units with forced draft

These gas-fired air heaters are absolutely new in that they can either be wall-mounted (W) or ceiling-mounted (WR). Thanks to the special patented gas burner they are the ideal solution for heating homes, commercial spaces, offices, professional studios, etc.

The two-speed fan makes it possible to reach the desired temperature very quickly and then maintain it with remarkable fuel consumption saving. The direction of the air delivery grates is adjustable and the intake filter limits the impurities suspended in the air. The wall-mounted model incorporates the standard control panel, while the ceiling-mounted version is remote controlled. The combustion cycle is air tight. A slight vacuum with respect to the installation area is achieved by the fume extractor located downstream of the exchanger. The differential safety air pressure switch guarantees that the combustion products are properly discharged, cutting off burner operation if the combustion circuit becomes plugged.

The electronic control unit has the following features: direct burner ignition and ionisation flame control. The WD series (with ducts) has been designed in order to service several areas with a single unit thanks to rigid or flexible ducts. Available in two capacities, the ceiling-mounted model has a galvanised sheet-metal casing. It is ideal for installation in false ceilings or in service areas. This model can provide partial or full outside air exchange by using the special plenum provided as an accessory.

For all three models the intake and exhaust kits come standard with separate rigid pipes and the related terminals for wall up to 40 cm thick. The maximum length for intake and exhaust ducts is 300+300 cm without elbows.



mod. W



mod. WR



mod. WD

Model		nominal thermal power		thermal power		
		kW	kcal/h	kW	kcal/h	
Wall-mounted electronic model W10	code 35250000P	10.50	9,030	9.24	7,950	1.720.00
Ceiling-mounted electronic model WR10	code 35250000S	10.50	9,030	9.24	7,950	1.810.00
Ducted electronic model WD10	code 35250000D	10.50	9,030	9.24	7,950	1.810.00

(*) Models W (wall-mounted) are equipped with intake and exhaust kit
Model WR-WD (ceiling-mounted) are equipped with intake and exhaust kit

Thanks to heaters W-WR-WD the temperature desired is quickly reached and fuel consumption saving can amount to 30%. All you need to install the W-R units are a gas feed line and a power supply outlet. There is no need to have a water supply line and an exhaust flue. A cardboard template is supplied to correctly carry out the wall connections needed.

The gas-fired heater W is equipped with two adjustable 2-speed centrifugal fans, although it can also operate with a single fan (summer ventilation). The low thermal head of treated air permits excellent distribution of the air, thus achieving great environmental comfort.

The combustion cycle is air-tight, sealed off from the room where the unit is installed. Combustion air is taken in from the outside and combustion products are fan-discharged to the outside. A safety device constantly checks circuit operation, ensuring reliability and safety.

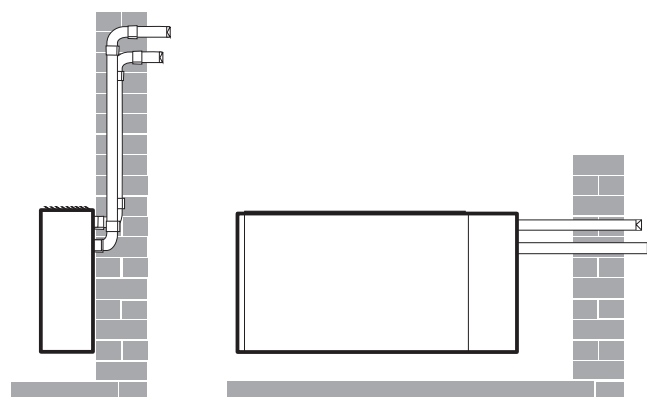

Separate intake and exhaust ducts allow for particular developments - with elbows too.

model W (wall-mounted)

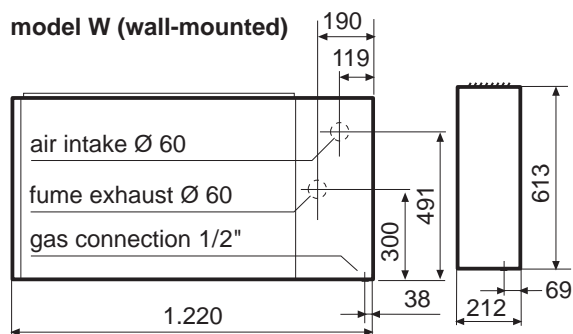

model WR (ceiling-mounted)

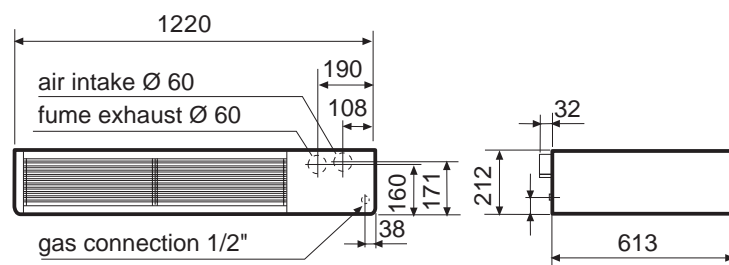

model WD (ducted)

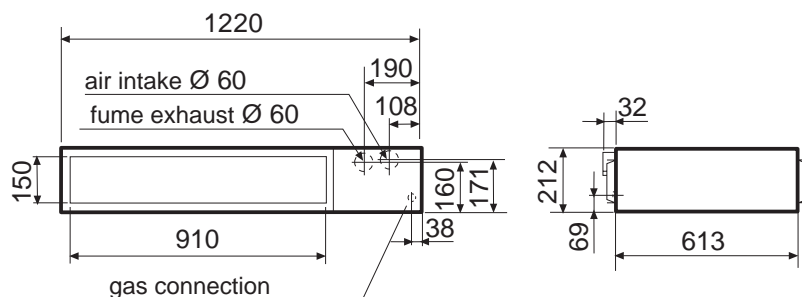

Accessories W - WR

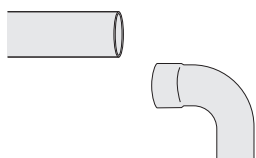

pipes and elbow 90° Ø 60 (also for model WD)

pipe m 0,5 code 37500045	37.00
pipe m 1 code 37500050	42.00
elbow 90° code 37800020	37.00

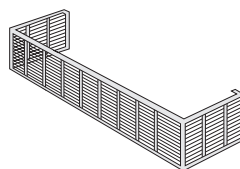

painted sheet-metal
molding to cover WR connections
code 37065000

99.00

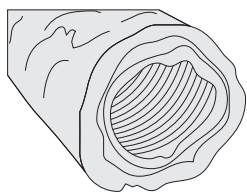
Accessories WD

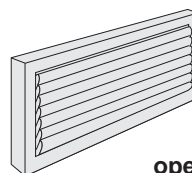

flexible insulated PVC pipe
for ducting - in 6 m packages Ø 200
code 37900001

119.00

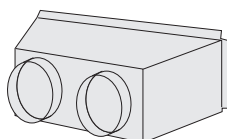

opening
cm 40x20 code 37900021

delivery opening
with adjustable fins
complete with gate

68.00

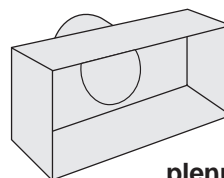

ducted delivery plenum
for flexible pipes
code 37060904

269.00

plenum
Ø 200 code 37900019

connection plenum between
flexible pipe and delivery opening
code 37900021

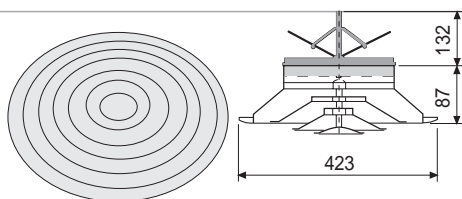
83.00



circular cone
diffusers
- adjustable
in millimetres
- plus calibration
butterfly gate

Ø 200

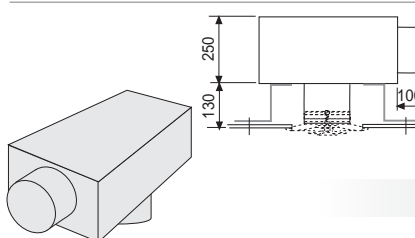
diffuser code 37900027	62.00
gate code 37900029	31.00

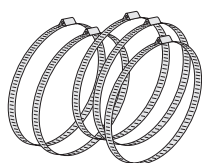

connection plenum
between flexible
pipe and adjustable
cone circular diffuser
code 37900031

83.00

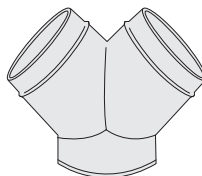

10 clamps
Ø 60 - 325
code 37900017

42.00



135° Y branch
Ø 200
code 37900010

114.00

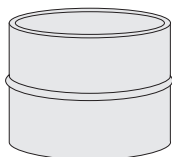

Ø 200 flexible pipe
junction coupling
code 37900051

21.00

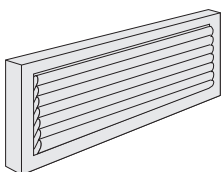

griglia di transito sottoporta
cm 40x15
code 37900015

57.00

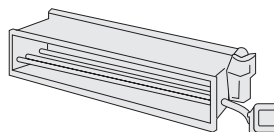

gate with inside/outside
air intake plenum for air exchange
with WR-WD models

gate

manual code 35250050

186.00

motor kit code 35250057

362.00

plenum grates

inside code 35250500

145.00

outside code 35250501

145.00

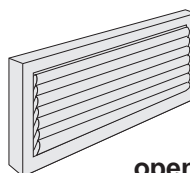

opening

cm 60x30 code 37900022

delivery opening
with adjustable fins
complete with gate

99.00

Inside unit

Ducted delivery plenum

Delivery opening

Delivery opening
connection plenum

Y branch

Insulated flexible pipe

Circular diffusers

Remote control

Inside/outside air intake plenum

Outside air intake duct

Fume flue

Combustion air uptake

Indoor air intake

Motor intake plenum
remote control

Detail of the new electronics-dedicated control panel mounted on gas-fired convection heater (version W -wall-mounted). For versions WR (ceiling-mounted) and WD (ducted ceiling-mounted), the remote control is supplied as standard.



